

# Eligo ELX94

**Art. no.** ELX94SLF-DW  
**GTIN** 7393069019179

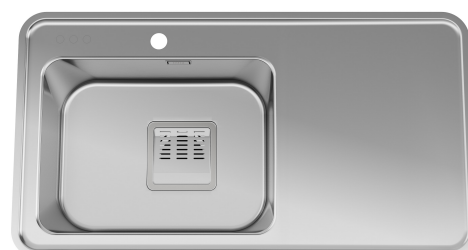
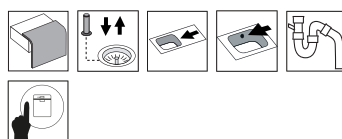

<b>Cabinet size</b>	60
<b>Overall dimension in mm</b>	940x510
<b>Depth in mm</b>	180
<b>Bowl dim. in mm</b>	480x360x180
<b>Cut-out dimension, inset model</b>	924 x 494, R49
<b>Radius</b>	49
<b>Waste hole dim. in mm</b>	97
<b>Material</b>	EN 1.4301, AISI 304, SS2333
<b>Material thickness in mm</b>	0,9

## Description

Eligo is a sink that is designed for real needs and kitchens. The award-winning design is an addition to the kitchen's interior, with its mix of soft and hard lines, discrete touch buttons and changing shapes.

Included Optional

