

# Bowl SK7030wall

**Art. no.** SK7030VEGG  
**GTIN** 7393069022841



## Description

Commercial bowl SK7030 in stainless steel, for wall mounting. Supplied with steel brackets and basket waste with overflow.

<b>Overall dimension in mm</b>	732 x 532 x 300
<b>Depth in mm</b>	300
<b>Bowl dim. in mm</b>	700 x 500 x 300
<b>Radius</b>	20
<b>Waste hole dim. in mm</b>	97
<b>Material</b>	AISI 304
<b>Material thickness in mm</b>	1,25
<b>Installation height in mm</b>	900
<b>Product load in N</b>	1000
<b>Net weight in kg</b>	10.43
<b>Pcs per pallet</b>	10

## Installation

Fix the enclosed steel brackets to the holders under the flange. Lock them with the supplied washers and nuts. Then, fix the bowl to the wall through the 4 fixing holes in the brackets. Screws and plugs are not supplied.

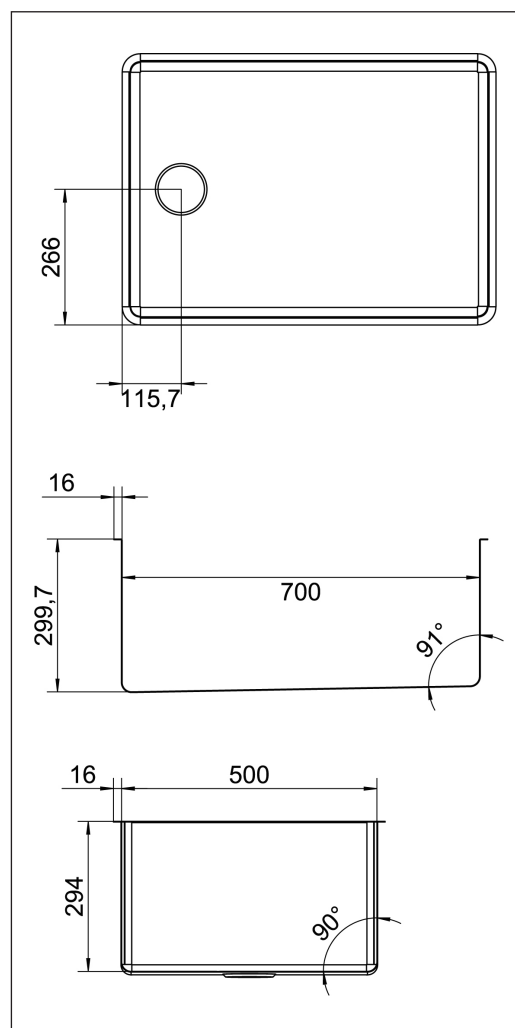

# Installation SK7030wall

## Mounting:

### Included in the box:

- \* Sink
- \* Wall brackets
- \* Waste 1 1/2" w/overflow
- \* 4 pcs hex nuts
- \* 4 pcs washers

The enclosed steel brackets are attached to the bowl with the console brackets and locked with the enclosed washers and nuts. Also install the valve and

overflow before the bowl is fixed to the wall. The bowl is fixed to the wall through the four mounting holes in the wall brackets. Wall screws and plugs are not included, but must be adapted to the wall type at place.

## Spare parts:

Waste 1 1/2" w/overflow: 79001

Wall brackets: YKONSOLL70

# Maintenance SK7030wall

## MAINTENANCE: INTRA PRODUCTS OF STAINLESS STEEL

Several of our products are delivered entirely or partly covered with plastic wrapping. This wrapping protects the products during transport. This wrapping must be removed before using the products.

In order for your Intra stainless steel product AISI304 to retain its original quality and appearance we recommend regular cleaning. Use mild soap or cleaning products specifically designed for stainless steel and clean water. Then wipe the surface with a dry cloth. Never use detergents containing chlorine, iodine, fluoride or abrasives on stainless steel. Also avoid contact with acid solutions and other substances incompatible with stainless steel. Remember that food and skin care products may contain such substances, e.g. ketchup, juice, salt, certain cleansers, nail polish, etc. Promptly remove spills of such products.

Observe the following:

- \* Do not allow water or other liquid to dry in. This is to avoid staining the surface.
- \* Even though stainless steel can withstand harsh treatment, it can easily be scratched by sharp objects. For products with normal, polished (brushed) finish, this will be very visible when the product is new, but after a period of use, this will be negated as the steel loses its lustre. For products with satin and polished finishes, the scratches will always be visible. Never use scouring powder or steel wool on stainless steel. In addition to scratching the steel, wire wool will leave behind small particles that may develop into rust spots which, over time, may corrode the steel.
- \* Stainless steel must not come into contact with, or be in environments containing, chlorine solutions for long periods of time.
- \* Silver polish causes stains which cannot be removed.