

Nivis NIVD82SF

Art. no. NIVD82SLF
GTIN 7393069026375

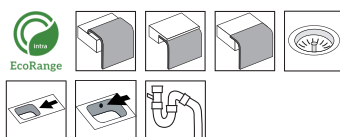

Art. no. NIVD82SRF
GTIN 7393069026405

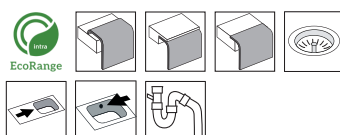

Art. no. NIVD82SF
GTIN 7393069026351

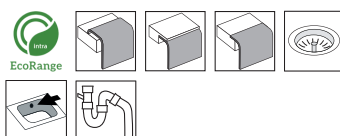

Art. no. NIVD82SF-0KH
GTIN 7393069026368
DB no. 2422447

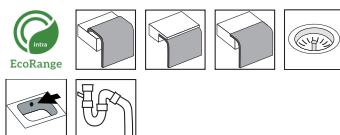

Cabinet size	60
Overall dimension in mm	820 x 515
Bowl dim. in mm	450 x 400 x 160
Cut-out dimension, inset model	802 x 497, R45
Waste hole dim. in mm	97
Material	EN 1.4301, AISI 304, SS2333
Material thickness in mm	0,7
Net weight in kg	6.00
Pcs per pallet	13

Description

Intra Nivis kitchen sink with one big bowl and drainer. The pattern on the drainer is well balanced against the flat surface and resemble tracks in the snow or furrows of drifting snow formed by the wind.

Nivis has an updated design with soft transitions and a fine balance between radiuses and shapes that results in a functional and elegant kitchen sink.

Supplied with basket waste, overflow and water trap. With a universal flange, for easy installation regardless if it is for inset, under- or flush mount. We have high demands on quality and a focus on sustainability in all processes!

Optional

