

# Nivis NIVD112DF

**Art. no.** NIVD112DF  
**GTIN** 7393069026542

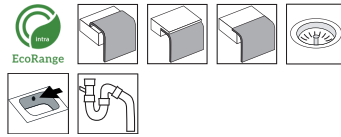

**Art. no.** NIVD112DF-0KH  
**GTIN** 7393069026559

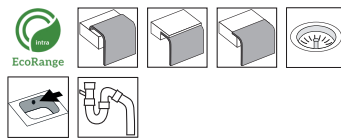

**Art. no.** NIVD112DLF  
**GTIN** 7393069026566

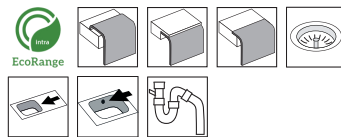

**Art. no.** NIVD112DRF  
**GTIN** 7393069026597

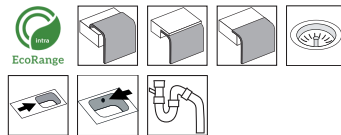

<b>Cabinet size</b>	80
<b>Overall dimension in mm</b>	1125 x 515
<b>Bowl dim. in mm</b>	345 x 415 x 160
<b>Cut-out dimension, inset model</b>	1107 x 497, R45
<b>Waste hole dim. in mm</b>	97
<b>Material</b>	EN 1.4301, AISI 304, SS2333
<b>Material thickness in mm</b>	0,7
<b>Gross weight in kg</b>	9.00
<b>Net weight in kg</b>	8.00
<b>Pcs per pallet</b>	10

## Description

Intra Nivis kitchen sink with two big bowls and drainage surface. The pattern on the drainer is well balanced against the flat surface and resemble tracks in the snow or furrows of drifting snow formed by the wind.

Nivis has an updated design with soft transitions and a fine balance between radiuses and shapes that results in a functional and elegant kitchen sink.

Supplied with basket waste, overflow and water trap. With a universal flange, for easy installation regardless if it is for inset, under- or flush mount. We have high demands on quality and a focus on sustainability in all processes!

Optional

