

Drink. fountain LVR-32-S-DF

Art. no.
GTIN

LVR-32-S-DF
7393069023879

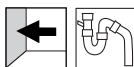

Overall dimension in mm	410 x 420 x 250
Depth in mm	250
Material	Stainless steel AISI 304
Material thickness in mm	1 / 1,5
Gross weight in kg	5.70
Net weight in kg	4.50

Description

Wall hung drinking fountain made of stainless steel. Supplied with a perforated drain (Vandal proof and hygienic without plug). With closed shroud for concealed in- and outlet and removable inspection panel with security screws at the bottom. Supplied with integrated waste, water trap and water bubbler.