

Drink. fountain LVR-32-S-DFB

Art. no. LVR-32-S-DFB
GTIN 7393069023886

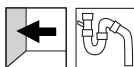

Overall dimension in mm 410 x 420 x 250
Depth in mm 250
Material Stainless steel AISI 304
Material thickness in mm 1 / 1,5
Gross weight in kg 6.20
Net weight in kg 5.00

Description

Wall hung drinking fountain made of stainless steel. Supplied with a perforated drain (Vandal proof and hygienic without plug). With closed shroud for concealed in- and outlet and removable inspection panel with security screws at the bottom. Supplied with integrated waste, water trap, water bubbler and bottle filler.

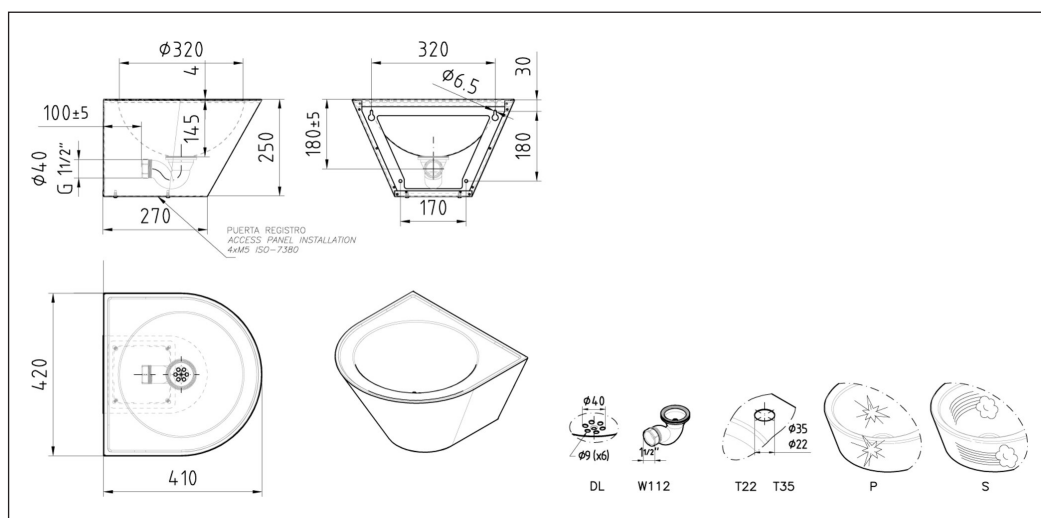

Installation LVR-32-S-DFB

See drawing.

